

RESIDENCE

TYPE

B

GF

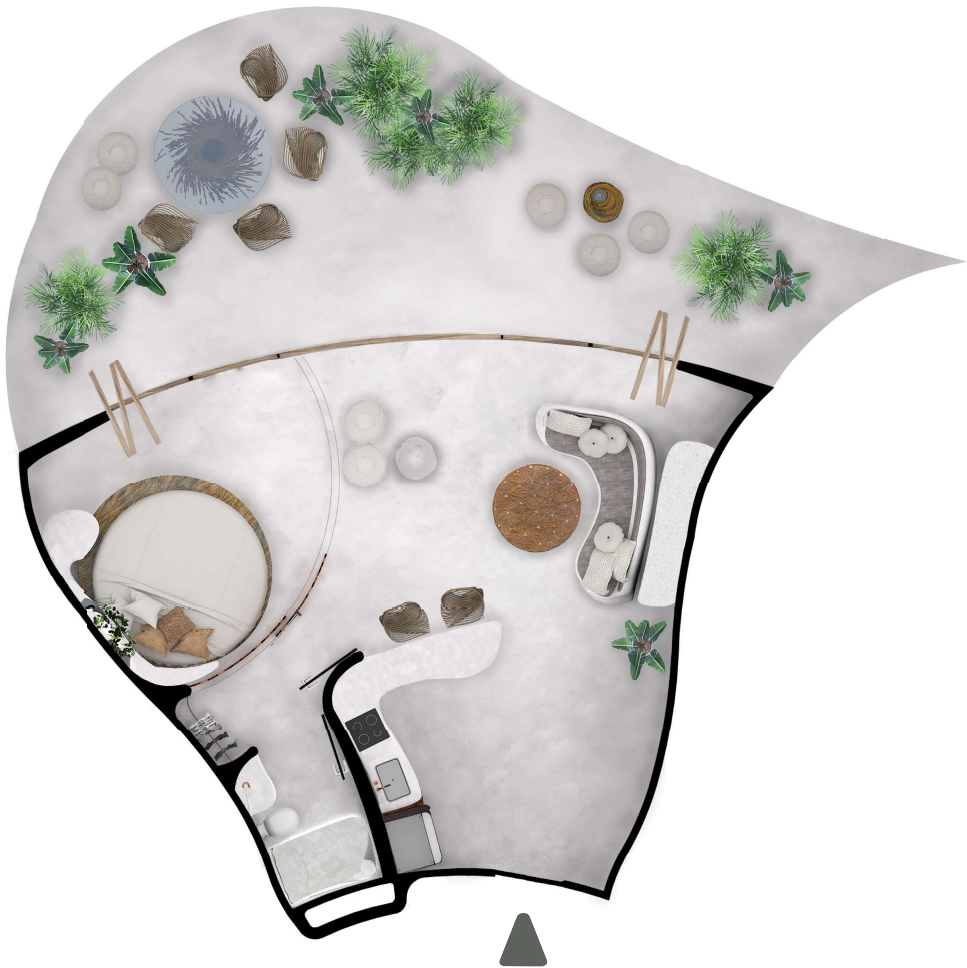

DESCRIPTION

Kitchen, living-dining room, one bedroom, one bathroom with closet, terrace and a parking slot.

GF

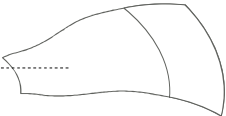

AREAS

2 apartments per tower

Ground Floor

Interior: 65 m²
Terrace: 50 m²

TOTAL
115 m²

GF

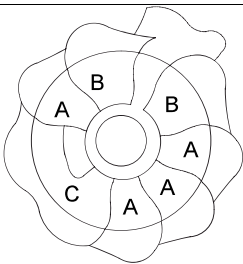

L 1

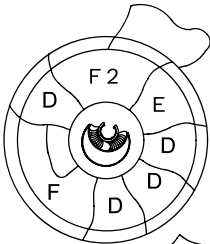

L 2

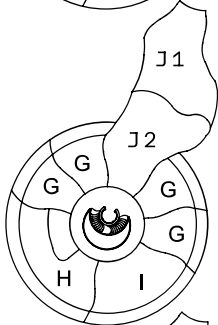

L 3

